

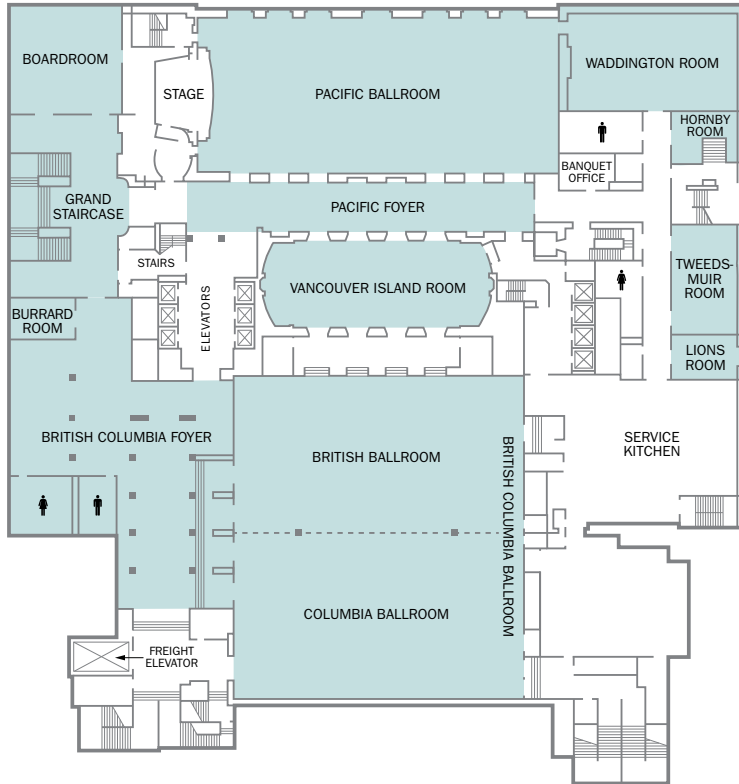

FLOOR PLAN

CONFERENCE FLOOR



CAPACITY CHART

| | OVERALL DIMENSIONS | | SQUARE | | HEIGHT | | CAPACITIES | | | | | | |
|----------------------------------|--------------------|-------------|--------|--------|--------|--------|------------|---------|-----------|-----------|-----------|--------|---------------|
| | FEET | METRES | FEET | METRES | FEET | METRES | ROUNDS | THEATRE | CLASSROOM | BOARDROOM | RECEPTION | USHAPE | HOLLOW SQUARE |
| BC BALLROOM | 100' x 114' | 30.5 x 34.7 | 11,400 | 1,058 | 14' 4" | 4.4 | 1000 | 1500 | 612 | - | 1500 | - | - |
| BC FOYER | | | 4,600 | 427 | 9' 6" | 2.9 | | | | | | | |
| BRITISH BALLROOM | 100' x 54' 4" | 30.5 x 16.5 | 5,430 | 503 | 14' 4" | 4.4 | 500 | 700 | 270 | 82 | 800 | 102 | 126 |
| COLUMBIA BALLROOM | 100' x 59' 5" | 30.5 x 18.1 | 5,940 | 552 | 14' 4" | 4.4 | 500 | 700 | 270 | 82 | 800 | 102 | 126 |
| GRAND STAIRCASE | | | 1,510 | 140 | 15' 6" | 4.7 | | | | | | | |
| PACIFIC BALLROOM | 128' x 54' | 39 x 16.5 | 6,900 | 644 | 23' 6" | 7.2 | 550 | 744 | 360 | 106 | 1000 | 132 | 150 |
| PACIFIC FOYER | | | 1,615 | 150 | 11' | 3.4 | | | | | | | |
| VANCOUVER ISLAND | 80' x 31' | 24.4 x 9.5 | 2,500 | 232 | 16' | 4.9 | 200 | 252 | 132 | 70 | 300 | 72 | 84 |
| WADDINGTON | 59' x 34' | 18 x 10.4 | 2,000 | 187 | 11' 6" | 3.5 | 150 | 192 | 96 | 52 | 200 | 60 | 70 |
| BOARDROOM | 36' x 34' | 11 x 10.4 | 1,224 | 114 | 18' | 5.5 | 90 | 128 | 60 | 32 | 150 | 36 | 48 |
| TWEEDSMUIR | 38' x 22' | 11.6 x 6.7 | 836 | 78 | 11' | 3.4 | 60 | 72 | 36 | 34 | 70 | 30 | 36 |
| LIONS | 22' x 14' | 6.7 x 4.3 | 310 | 29 | 11' | 3.4 | 20 | 20 | 9 | 16 | 20 | - | - |
| BURRARD | 19' x 10' | 5.8 x 3 | 200 | 17 | 11' | 3.4 | 10 | - | - | 16 | - | - | - |
| HORNBY | 20' x 10' | 6.1 x 3 | 200 | 18 | 11' | 3.4 | 10 | - | - | 12 | - | - | - |

FLOOR PLAN

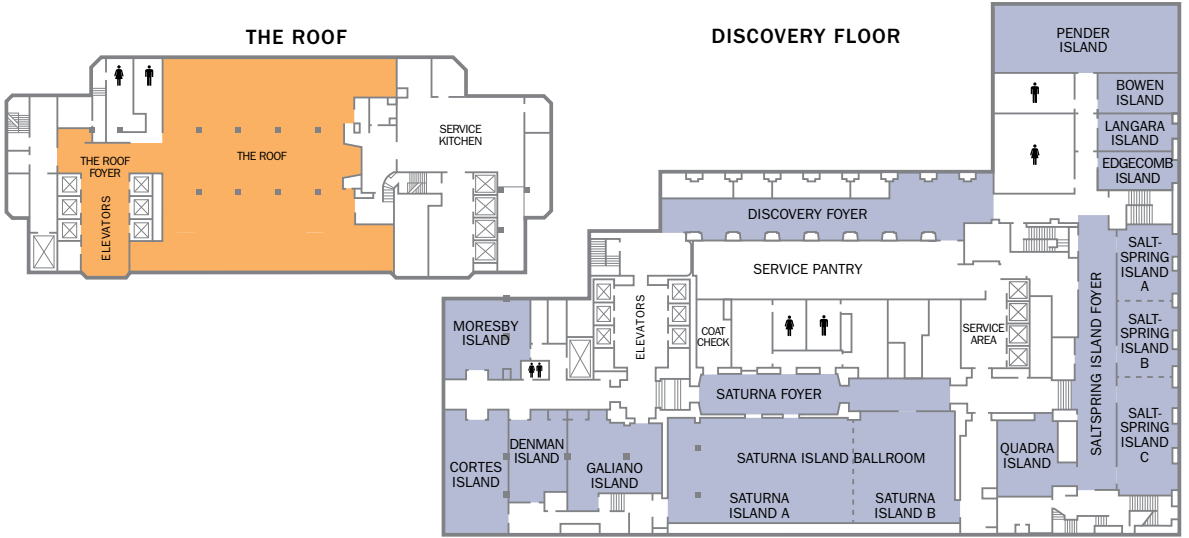

CAPACITY CHART

| | OVERALL DIMENSIONS | | SQUARE | | HEIGHT | | CAPACITIES | | | | | | |
|---|--------------------|-------------|--------|--------|--------|--------|------------|---------|-----------|-----------|-----------|--------|---------------|
| | FEET | METRES | FEET | METRES | FEET | METRES | ROUNDS | THEATRE | CLASSROOM | BOARDROOM | RECEPTION | USHAPE | HOLLOW SQUARE |
| DISCOVERY FLOOR | | | | | | | | | | | | | |
| DISCOVERY FOYER | | | 1,695 | 157 | 9' | 2.7 | | | | | | | |
| SATURNA ISLAND | 104' x 36' | 31.7 x 11 | 3,800 | 348 | 11' | 3.5 | 240 | 320 | 120 | 56 | 325 | 60 | 64 |
| SATURNA A | 67' x 36' | 20.4 x 11 | 2412 | 224 | 11' | 3.35 | 150 | 160 | 72 | 40 | 205 | 36 | 40 |
| SATURNA B | 37' x 36' | 11.2 x 11 | 1332 | 124 | 11' | 3.35 | 90 | 128 | 40 | 20 | 120 | 24 | 32 |
| SATURNA FOYER | | | 1065 | 98 | 11' | 3.4 | | | | | | | |
| SALTSPRING ISLAND | 93' x 21' | 28.3 x 6.4 | 1,953 | 181 | 10' | 3.1 | 170 | - | 108 | 88 | 170 | - | - |
| SALTSPRING ISLAND FOYER | | | 1,240 | 115 | 8' | 2.4 | | | | | | | |
| SALTSPRING ISLAND A | 26' 9" x 21' | 8.2 x 6.4 | 562 | 52 | 10' | 3.1 | 40 | 50 | 24 | 22 | 50 | 24 | 24 |
| SALTSPRING ISLAND B | 26' x 21' | 7.9 x 6.4 | 545 | 50 | 10' | 3.1 | 40 | 50 | 24 | 22 | 50 | 24 | 24 |
| SALTSPRING ISLAND A & B | 52' 10" x 21' | 16.1 x 6.4 | 1,107 | 102 | 10' | 3.1 | 80 | 96 | 54 | 46 | 100 | 42 | 48 |
| SALTSPRING ISLAND C | 40' 4" x 21' | 12.3 x 6.4 | 846 | 79 | 10' | 3.1 | 70 | 70 | 42 | 46 | 70 | 36 | 42 |
| SALTSPRING ISLAND B & C | 66' 5" x 21' | 20.2 x 6.4 | 1,391 | 129 | 10' | 3.1 | 110 | 128 | 72 | 58 | 120 | 54 | 66 |
| PENDER ISLAND | 64' x 24' | 19.5 x 7.3 | 1,535 | 142 | 9' 6" | 2.9 | 60 | 60 | 58 | 48 | 60 | 60 | 60 |
| GALIANO ISLAND | 34' x 26' | 10.4 x 7.9 | 884 | 82 | 9' | 2.7 | 40 | 40 | 18 | 20 | 60 | 18 | 24 |
| CORTES ISLAND | 38' x 19' | 11.6 x 5.8 | 722 | 67 | 11' | 3.4 | 60 | 64 | 30 | 28 | 70 | 24 | 30 |
| MORESBY ISLAND | 30' x 23' | 9.1 x 7 | 690 | 64 | 11' | 3.4 | 40 | 40 | 18 | 22 | 60 | 18 | 24 |
| QUADRA ISLAND | 26' 4" x 20' | 8 x 6.1 | 526 | 49 | 9' 6" | 2.9 | 40 | 48 | 24 | 22 | 60 | 18 | 24 |
| DENMAN ISLAND | 29' x 19' | 7.9 x 5.8 | 494 | 46 | 9' | 2.7 | 40 | 40 | 18 | 22 | 40 | 18 | 24 |
| BOWEN ISLAND | 28' x 11' | 8.5 x 3.4 | 308 | 29 | 9' 6" | 2.9 | - | - | - | 14 | - | - | - |
| LANGARA ISLAND | 28' x 11' | 8.5 x 3.4 | 308 | 29 | 9' 6" | 2.9 | - | - | - | 14 | - | - | - |
| EDGECOMB ISLAND | 28' x 11' | 8.5 x 3.4 | 308 | 29 | 9' 6" | 2.9 | 20 | 24 | 12 | 16 | 25 | - | - |
| THE ROOF | | | | | | | | | | | | | |
| THE ROOF | 80 x 40 | 24.4 x 12.2 | 5,200 | 500 | 11' | 3.4 | 260 | 230 | 72 | 48 | 300 | 38 | 44 |
| THE ROOF FOYER | | | 750 | 69 | 9' | 2.7 | | | | | | | |

Fairmont Hotel Vancouver
 900 West Georgia Street
 Vancouver, British Columbia
 Canada V6C 2W6
 T +1 604 684 3131
 F +1 604 662 1907
 rfp-hvc@fairmont.com
 fairmont.com/hotelvancouver